

BEDROOM PLAN

<u>Room</u>	<u>Beds</u>
1	sleeps 8
2	sleeps 6
3	sleeps 6
4	sleeps 7
5	sleeps 1
6	sleeps 4
7	sleeps 6
8	sleeps 6
9	sleeps 2
10	sleeps 1
11	sleeps 1
12	sleeps 6

Please note: all single rooms have ensuite facilities

A	en-suite bathroom
B	2 toilet and shower cubicles
C	3 toilets, 1 shower
Downstairs:	Gents: 3 showers

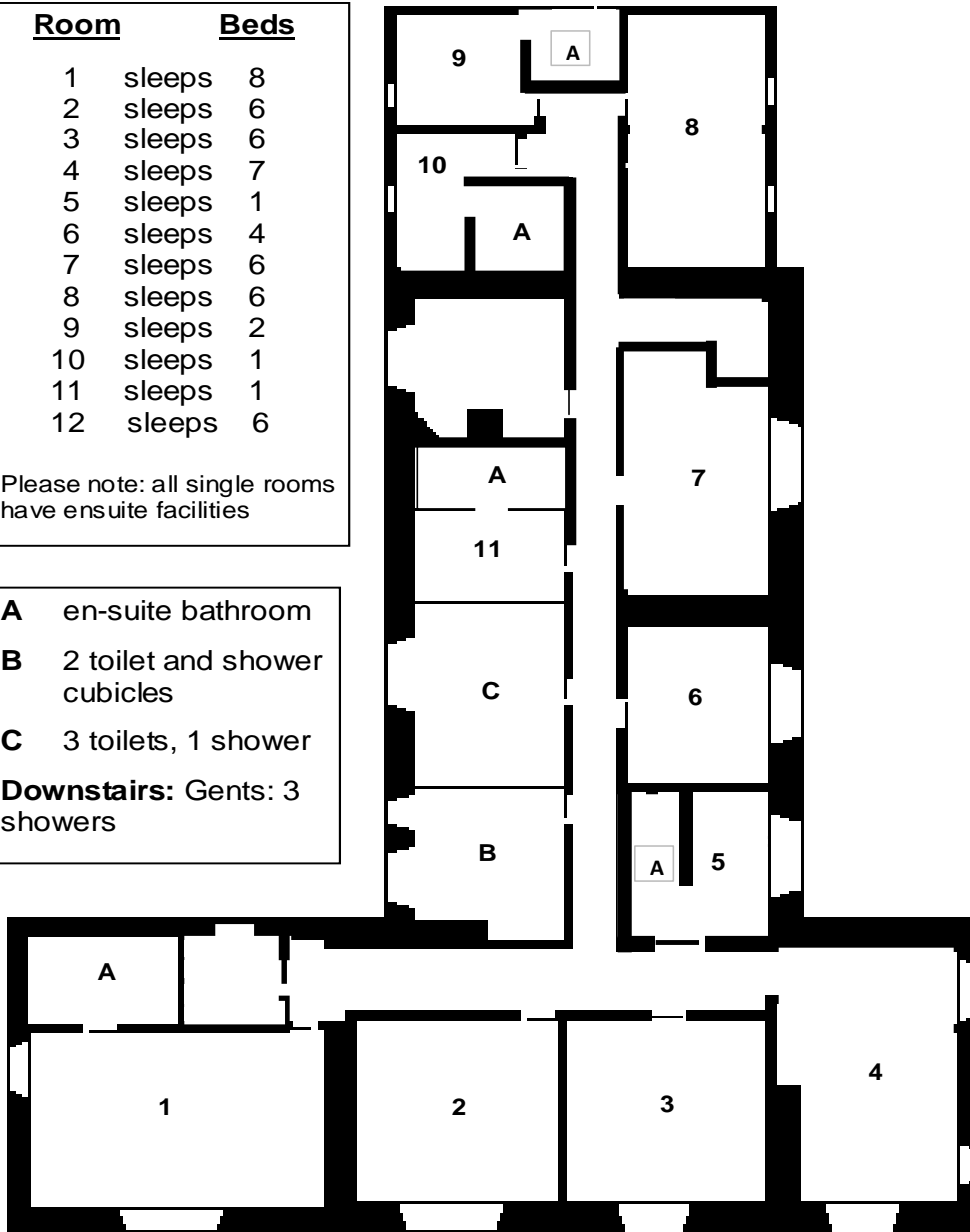

Notes:

Room 12 (sleeps 6) is downstairs and not on this floorplan, it should only be used if all upstairs rooms have been used or for guests with restricted mobility

Practically it makes sense for rooms 1-3 for girls, and 6-8 for boys (closer to stairwell to boys toilets). Room 4 can be either. Additionally rooms 1,2,3 and 4 can have an extra pull out bed but this is suggested to be only used as a last resort